

FAG

2206-2RS-TVH

Self-aligning ball bearing

Schaeffler ID:
0167027600000Self-aligning ball bearing 22..-2RS-TVH,
seals, plastic cage

Technical information

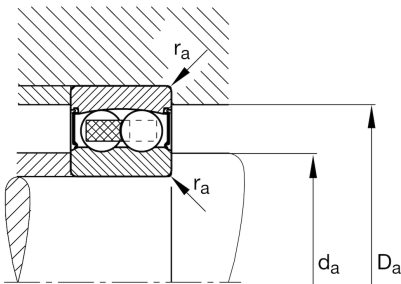
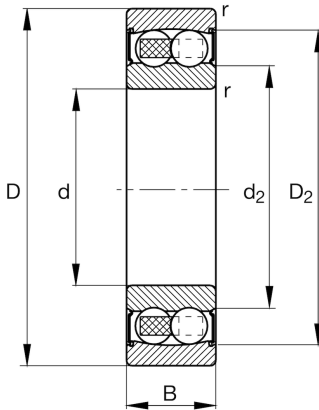
**Main Dimensions & Performance Data**

d	30 mm	Bore diameter
D	62 mm	Outside diameter
B	20 mm	Width
r_{\min}	1 mm	Minimum chamfer dimension
C_r	15.900 N	Basic dynamic load rating, radial
C_{0r}	4.650 N	Basic static load rating, radial
C_{ur}	295 N	Fatigue load limit, radial
n_G	6.800 1/min	Limiting speed
	265 g	Weight

Dimensions

D_2	53,3 mm	Caliber diameter outer ring
d_2	37,3 mm	Caliber diameter inner ring

Mounting dimensions

$d_{a\min}$	35,6 mm	Minimum diameter shaft shoulder
$D_{a\max}$	56,4 mm	Maximum diameter of housing shoulder
$r_{a\max}$	1 mm	Maximum fillet radius

Calculation factors

e	0,25	Limiting value of F_a/F_r for the applicability of diff. Values of factors X and Y
Y_1	2,54	Dynamic axial load factor
Y_2	3,93	Dynamic axial load factor
Y_0	2,66	Static axial load factor

Temperature range

T_{\min}	-20 °C	Operating temperature min.
T_{\max}	100 °C	Operating temperature max.